

Pegler Valve

Bronze globe valve BS 5154 PN32 Series B, metal disk

1031 Globe valve



General Information

Size	Pattern No.	Pack 1 Qty	Pack 2 Qty	Code	Barcode	Price (£) each ex VAT
1/2"	1031	10	0	112007	5013866013287	£54.31
3/4"	1031	5	0	112008	5013866013294	£73.95
1"	1031	5	0	112009	5013866013300	£113.04
1.1/4"	1031	2	0	112010	5013866013317	£159.53
1.1/2"	1031	2	0	112011	5013866013324	£198.07
2"	1031	1	5	112012	5022050545626	£313.77
1/2"	1031 PT	10	0	112047	5022050566454	£54.31
3/4"	1031 PT	5	0	112048	5022050288004	£73.95
1"	1031 PT	5	0	112049	5022050228093	£113.04
1.1/4"	1031 PT	2	0	112050	5022050288073	£159.53
1.1/2"	1031 PT	2	0	112051	5022050318497	£198.07
2"	1031 PT	1	5	112052	5022050576095	£314.18

1031 Globe valve

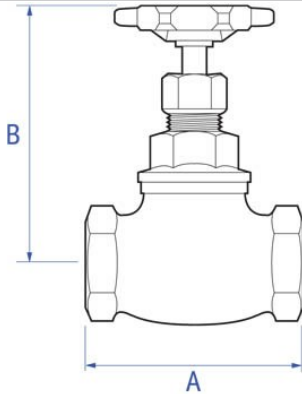

Dimensions

Code	Description	A	B
112007	1/2" 1031 GM GLOBE VALVE	57	95 0.39
112008	3/4" 1031 GM GLOBE VALVE	65	100 0.55
112009	1" 1031 GM GLOBE VALVE	78	114 0.87
112010	1.1/4" 1031 GM GLOBE VALVE	89	138 1.45
112011	1.1/2" 1031 GM GLOBE VALVE	100	159 1.83
112012	2" 1031 GM GLOBE VALVE	121	170 2.61
112047	1/2" 1031 PT GM GLOBE VALVE	57	95 0.38
112048	3/4" 1031 PT GM GLOBE VALVE	65	98 0.54
112049	1" 1031 PT GM GLOBE VALVE	78	114 0.84
112050	1.1/4" 1031 PT GM GLOBE VALVE	89	138 1.36
112051	1.1/2" 1031 PT GM GLOBE VALVE	100	159 1.84
112052	2" 1031 PT GM GLOBE VALVE	121	170 2.80

Pegler Yorkshire reserve the right to change specifications

Flow Rate

Size	Pattern No.	Code	Kv m3/h
1/2"	1031	112007	2.30
3/4"	1031	112008	5.90
1"	1031	112009	11.70
1.1/4"	1031	112010	18.70
1.1/2"	1031	112011	26.90
2"	1031	112012	49.10
1/2"	1031 PT	112047	
3/4"	1031 PT	112048	
1"	1031 PT	112049	
1.1/4"	1031 PT	112050	
1.1/2"	1031 PT	112051	
2"	1031 PT	112052	

Pegler Yorkshire reserve the right to change specifications

Pressure and Temperature

Description	Minimum Operating Pressure (bar)	Maximum Cold Working Pressure (bar)	Maximum Hot Working Pressure (bar)
1031 Globe valve	No Minimum Operating Pressure	32.0 bar at temperatures up to 100oC	14.0 bar at temperatures up to 198oC

Care and Maintenance

Care

No regular aesthetic care is required for this product

Maintenance

A regular maintenance program is the most efficient method of ensuring longer term operational efficiency of the selected valve. Such a program would need to include a risk assessment and a planned procedure of how the maintenance will be carried out. The possibility of operational limits being exceeded and the potential hazards ensuring must be considered as part of this assessment. This should be implemented to include visual checks on the valve's condition and any development of unforeseen conditions, which could lead to failure. The correct fitting tools and equipment should be used for valve maintenance work. Separate means of draining the pipe work must be provided when carrying out any maintenance to valves. Where there may be any system debris this could be collected and /or filtered by installation of the appropriate protective device.

For further help please contact your local engineer.

If your product is under warranty please contact the Service Support Team on: 0800 1560050

Regulations

Regulations

THE PRESSURE EQUIPMENT DIRECTIVE 97/23/EC and CE MARKING

The Pressure Equipment Regulations 1999 (SI 1999/2001) have now been introduced into United Kingdom law.

Valves with a maximum allowable pressure greater than 0.5 bar are covered by these new Regulations. Valves are categorised according to their maximum working pressure, size and rising level of hazard. The level of hazard varies according to the fluid being carried. Fluids are classified as Group 1, dangerous fluids or Group 2, all other fluids including steam. The Categories designated are SEP (sound engineering practice). Valves up to and including 25mm (1") are designated SEP regardless of the fluid group. Those identified as having increased hazard are Categorised as, I, II, III or IV. All valves designated as SEP do not bear the CE mark nor require a Declaration of Conformity. Categories I, II, III or IV carry the CE mark and require a Declaration of Conformity. Valves classified from the piping chart would not be included in Category IV.

Size Pattern No. Code PED Categorisation

1/2"	1031	112007	SEP
3/4"	1031	112008	SEP
1"	1031	112009	SEP
1.1/4"	1031	112010	SEP
1.1/2"	1031	112011	SEP
2"	1031	112012	SEP
1/2"	1031 PT	112047	-
3/4"	1031 PT	112048	-
1"	1031 PT	112049	-
1.1/4"	1031 PT	112050	-
1.1/2"	1031 PT	112051	-
2"	1031 PT	112052	-

Pegler Yorkshire reserve the right to change specifications

Materials

Component	Material
Body	Gunmetal
Bonnet	Forged Brass
Stem	Brass Bar
Disk Ring	Brass Bar

Component	Material
Disk	Brass Bar
Gland	Brass Bar
Gland Nut	Brass Bar
Packing	PTFE
Handwheel	Aluminium
Handwheel Nut	Brass Bar
Rating Disc	Aluminium

Flange Data

Size Code	Flange Diameter (mm)	Pitch Circle Diameter (mm)	No of Bolts	Bolt Diameter (mm)	Hole Diameter (mm)	Raised Face Diameter (mm)	Raised Face Height (mm)	Thickness of Flange (mm)
-----------	----------------------	----------------------------	-------------	--------------------	--------------------	---------------------------	-------------------------	--------------------------

Pegler Yorkshire reserve the right to change specifications

Technical Suitability

Steam	Water	Oil	Air	Gas	Inert Gas	Combustible†	Gas Corrosive††	Gas Oxygen
yes	yes	yes	yes	no	no	no	yes	no

Pegler Yorkshire reserve the right to change specifications

Gas application guide

Class 1. INERT Air, argon, carbon dioxide, helium, nitrogen

Class 2. COMBUSTIBLE Hydrogen, methane, natural gas, town gas

Class 3. CORROSIVE Chlorine, sulphur dioxide Class 4. OXYGEN

Class 1. INERT Air, argon, carbon dioxide, helium, nitrogen

† Valves are suitable for British Gas Applications Family Gases 1, 2 and 3.

†† Suitable in applications where moisture is completely absent.

1031 Globe valve

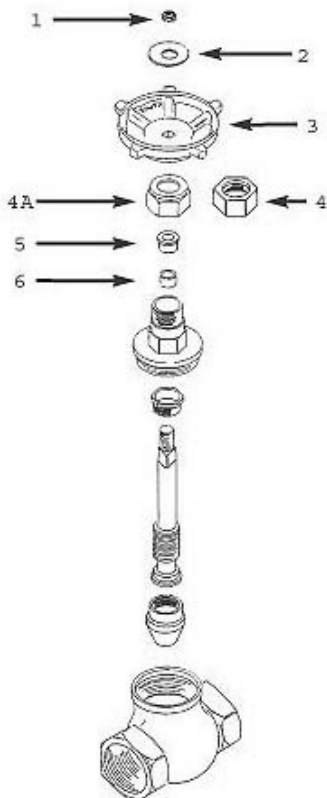

Spare Key	Description	Code	Barcode	Date From	Date To	Price (£) ex VAT
1						
1	WN1 HANDWHEEL NUT BRASS (M5)	850481	5013866060977	01/01/1900	To Current	£0.94
1	WN1 HANDWHEEL NUT BRASS (M5)	850481	5013866060977	01/01/1900	To Current	£0.94
1	WN2 HANDWHEEL NUT BRASS (M6)	850482	5013866060984	01/01/1900	To Current	£0.94
1	WN2 HANDWHEEL NUT BRASS (M6)	850482	5013866060984	01/01/1900	To Current	£0.94
1	WN2 HANDWHEEL NUT BRASS (M6)	850482	5013866060984	01/01/1900	To Current	£0.94
1	WN2 HANDWHEEL NUT BRASS (M6)	850482	5013866060984	01/01/1900	To Current	£0.94
1	WN2 HANDWHEEL NUT BRASS (M6)	850482	5013866060984	01/01/1900	To Current	£0.94
1	WN14 HANDWHEEL NUT BRASS (M8)	850512	5013866061141	01/09/1999	07/04/2022	£0.00
1	WN3 HANDWHEEL NUT BRASS (5/16 UNC)	851411	5013866063923	01/01/1990	08/03/2022	£0.00
1	WN4 HANDWHEEL NUT BRASS (3/8 UNC)	851412	5013866063930	01/01/1900	08/03/2022	£0.00
1	WN5 HANDWHEEL NUT BRASS (7/16 UNC)	850483	5013866060991	01/01/1900	08/03/2022	£0.00
1	WN6 HANDWHEEL NUT BRASS (1/2 UNC)	850484	5013866061004	01/01/1900	08/03/2022	£0.00
1	WN1 HANDWHEEL NUT BRASS (M5)	850481	5013866060977	01/01/1900	To Current	£0.94
1	WN1 HANDWHEEL NUT BRASS (M5)	850481	5013866060977	01/01/1900	To Current	£0.94
1	WN2 HANDWHEEL NUT BRASS (M6)	850482	5013866060984	01/01/1900	To Current	£0.94
1	WN2 HANDWHEEL NUT BRASS (M6)	850482	5013866060984	01/01/1900	To Current	£0.94
1	WN2 HANDWHEEL NUT BRASS (M6)	850482	5013866060984	01/01/1900	To Current	£0.94
1	WN2 HANDWHEEL NUT BRASS (M6)	850482	5013866060984	01/01/1900	To Current	£0.94
1	WN2 HANDWHEEL NUT BRASS (M6)	850482	5013866060984	01/01/1900	To Current	£0.94
1	WN2 HANDWHEEL NUT BRASS (M6)	850482	5013866060984	01/01/1900	To Current	£0.94
1	WN3 HANDWHEEL NUT BRASS (5/16 UNC)	851411	5013866063923	01/01/1990	08/03/2022	£0.00
1	WN14 HANDWHEEL NUT BRASS (M8)	850512	5013866061141	01/09/1999	07/04/2022	£0.00

Spare Key	Description	Code	Barcode	Date From	Date To	Price (£) ex VAT
-----------	-------------	------	---------	-----------	---------	------------------

Spare Key	Description	Code	Barcode	Date From	Date To	Price (£) ex VAT
-----------	-------------	------	---------	-----------	---------	------------------

2

2	RATING DISC 1031 - SIZE 1	850459	5013866060793	01/01/1900	05/10/2022	£1.07
2	RATING DISC 1031 - SIZE 1	850459	5013866060793	01/01/1900	05/10/2022	£1.07
2	RATING DISC 1031 - SIZE 1	850459	5013866060793	01/01/1900	05/10/2022	£1.07
2	RATING DISC 1031 - SIZE 1	850459	5013866060793	01/01/1900	05/10/2022	£1.07
2	RATING DISC 1031 - SIZE 1	850459	5013866060793	01/01/1900	05/10/2022	£1.07
2	RATING DISC 1031 - SIZE 1	850459	5013866060793	01/01/1900	05/10/2022	£1.07
2	RATING DISC 1031 - SIZE 1	850459	5013866060793	01/01/1900	05/10/2022	£1.07
2	RATING DISC 1031 - SIZE 2	850460	5013866060809	01/01/1900	03/11/2022	£2.18
2	RATING DISC 1031 - SIZE 3	850261	5013866059810	01/01/1900	04/10/2022	£3.22
2	RATING DISC 1031 - SIZE 3	850261	5013866059810	01/01/1900	04/10/2022	£3.22
2	RATING DISC 1031 - SIZE 3	850261	5013866059810	01/01/1900	04/10/2022	£3.22
2	RATING DISC 1031 - SIZE 1	850459	5013866060793	01/01/1900	05/10/2022	£1.07
2	RATING DISC 1031 - SIZE 1	850459	5013866060793	01/01/1900	05/10/2022	£1.07
2	RATING DISC 1031 - SIZE 1	850459	5013866060793	01/01/1900	05/10/2022	£1.07
2	RATING DISC 1031 - SIZE 1	850459	5013866060793	01/01/1900	05/10/2022	£1.07
2	RATING DISC 1031 - SIZE 1	850459	5013866060793	01/01/1900	05/10/2022	£1.07
2	RATING DISC 1031 - SIZE 1	850459	5013866060793	01/01/1900	05/10/2022	£1.07
2	RATING DISC 1031 - SIZE 1	850459	5013866060793	01/01/1900	05/10/2022	£1.07
2	RATING DISC 1031 - SIZE 1	850459	5013866060793	01/01/1900	05/10/2022	£1.07
2	RATING DISC 1031 - SIZE 2	850460	5013866060809	01/01/1900	03/11/2022	£2.18

Spare Key	Description	Code	Barcode	Date From	Date To	Price (£) ex VAT
-----------	-------------	------	---------	-----------	---------	------------------

3

3	W1 HANDWHEEL (RED)	850100	5013866059513	01/01/1900	To Current	£12.90
3	W1 HANDWHEEL (RED)	850100	5013866059513	01/01/1900	To Current	£12.90
3	W3 HANDWHEEL (RED)	850101	5013866059520	01/05/2000	To Current	£12.90
3	W4 HANDWHEEL (RED)	850102	5013866059537	01/01/1990	30/04/2000	£12.90
3	W4 HANDWHEEL (RED)	850102	5013866059537	01/01/1900	To Current	£12.90
3	W5 HANDWHEEL (RED)	850103	5013866059544	01/01/1900	To Current	£12.90
3	W6 HANDWHEEL (RED)	850104	5013866059551	01/01/1900	To Current	£20.44
3	W7 HANDWHEEL (RED)	850105	5013866059568	01/01/1900	To Current	£20.44
3	W8 HANDWHEEL (RED)	850106	5013866059575	01/01/1900	To Current	£20.44
3	W10 HANDWHEEL (RED)	850107	5013866059582	01/01/1900	To Current	£38.26
3	W12 HANDWHEEL (RED)	850108	5013866059599	01/01/1900	To Current	£177.71
3	W14 HANDWHEEL (RED)	850109	5013866059605	01/01/1900	08/03/2022	£0.00
3	W1 HANDWHEEL (RED)	850100	5013866059513	01/01/1900	To Current	£12.90
3	W1 HANDWHEEL (RED)	850100	5013866059513	01/01/1900	To Current	£12.90
3	W4 HANDWHEEL (RED)	850102	5013866059537	01/01/1990	30/04/2000	£12.90
3	W3 HANDWHEEL (RED)	850101	5013866059520	01/05/2000	To Current	£12.90
3	W4 HANDWHEEL (RED)	850102	5013866059537	01/01/1900	To Current	£12.90
3	W5 HANDWHEEL (RED)	850103	5013866059544	01/01/1900	To Current	£12.90
3	W6 HANDWHEEL (RED)	850104	5013866059551	01/01/1900	To Current	£20.44
3	W7 HANDWHEEL (RED)	850105	5013866059568	01/01/1900	To Current	£20.44
3	W8 HANDWHEEL (RED)	850106	5013866059575	01/01/1900	To Current	£20.44

Spare Key	Description	Code	Barcode	Date From	Date To	Price (£) ex VAT
-----------	-------------	------	---------	-----------	---------	------------------

4

4	GN1 GLAND NUT	850310	5013866059889	01/01/1990	08/03/2022	£0.00
4	GN1 GLAND NUT	850310	5013866059889	01/01/1990	08/03/2022	£0.00
4	GN3 GLAND NUT	842046	5013866059117	01/01/1900	To Current	£5.13
4	GN3 GLAND NUT	842046	5013866059117	01/01/1990	30/04/2000	£5.13
4	GN4 GLAND NUT	842048	5013866059124	01/01/1990	08/03/2022	£0.00
4	GN5 GLAND NUT	850311	5013866059896	01/01/1990	08/03/2022	£0.00
4	GN6 GLAND NUT	851070	5013866063879	01/01/1990	08/03/2022	£0.00
4	GN7 GLAND NUT	851205	5013866063909	01/01/1990	08/03/2022	£0.00

Spare Key	Description	Code	Barcode	Date From	Date To	Price (£) ex VAT
4	GN23 GLAND NUT	851029	5013866063862	01/01/1900	08/03/2022	£0.00
4	GN24 GLAND NUT	852907	5013866063985	01/01/1900	08/03/2022	£0.00
4	GN16 GLAND NUT	850318	5013866059957	01/01/1900	To Current	£10.73
4	GN1 GLAND NUT	850310	5013866059889	01/01/1990	08/03/2022	£0.00
4	GN1 GLAND NUT	850310	5013866059889	01/01/1990	08/03/2022	£0.00
4	GN3 GLAND NUT	842046	5013866059117	01/01/1900	To Current	£5.13
4	GN3 GLAND NUT	842046	5013866059117	01/01/1990	30/04/2000	£5.13
4	GN4 GLAND NUT	842048	5013866059124	01/01/1990	08/03/2022	£0.00
4	GN5 GLAND NUT	850311	5013866059896	01/01/1990	08/03/2022	£0.00
4	GN6 GLAND NUT	851070	5013866063879	01/01/1990	08/03/2022	£0.00
4	GN7 GLAND NUT	851205	5013866063909	01/01/1990	08/03/2022	£0.00

Spare Key	Description	Code	Barcode	Date From	Date To	Price (£) ex VAT
-----------	-------------	------	---------	-----------	---------	------------------

4A

4A	GN62 GLAND NUT (CHAMFERED)	850790	5013866062292	01/05/2000	08/03/2022	£0.00
4A	GN62 GLAND NUT (CHAMFERED)	850790	5013866062292	01/05/2000	08/03/2022	£0.00
4A	GN8 GLAND NUT	850312	5013866059902	01/05/2000	08/03/2022	£0.00
4A	GN8 GLAND NUT	850312	5013866059902	01/05/2000	08/03/2022	£0.00
4A	GN63 GLAND NUT (CHAMFERED)	850791	5013866062308	01/05/2000	08/03/2022	£0.00
4A	GN64 GLAND NUT (CHAMFERED)	850792	5013866062315	01/05/2000	08/03/2022	£0.00
4A	GN65 GLAND NUT (CHAMFERED)	850793	5013866062322	01/05/2000	To Current	£7.29
4A	GN66 GLAND NUT (CHAMFERED)	850794	5013866062339	01/05/2000	To Current	£8.58
4A	GN62 GLAND NUT (CHAMFERED)	850790	5013866062292	01/05/2000	08/03/2022	£0.00
4A	GN62 GLAND NUT (CHAMFERED)	850790	5013866062292	01/05/2000	08/03/2022	£0.00
4A	GN8 GLAND NUT	850312	5013866059902	01/05/2000	08/03/2022	£0.00
4A	GN8 GLAND NUT	850312	5013866059902	01/05/2000	08/03/2022	£0.00
4A	GN63 GLAND NUT (CHAMFERED)	850791	5013866062308	01/05/2000	08/03/2022	£0.00
4A	GN64 GLAND NUT (CHAMFERED)	850792	5013866062315	01/05/2000	08/03/2022	£0.00
4A	GN65 GLAND NUT (CHAMFERED)	850793	5013866062322	01/05/2000	To Current	£7.29
4A	GN66 GLAND NUT (CHAMFERED)	850794	5013866062339	01/05/2000	To Current	£8.58

Spare Key	Description	Code	Barcode	Date From	Date To	Price (£) ex VAT
-----------	-------------	------	---------	-----------	---------	------------------

5

5	G1 GLAND	855236	5013866065163	01/01/1900	08/03/2022	£0.00
5	G1 GLAND	855236	5013866065163	01/01/1900	08/03/2022	£0.00
5	G3 GLAND	842043	5013866059094	01/01/1900	To Current	£2.59
5	G3 GLAND	842043	5013866059094	01/01/1900	To Current	£2.59
5	G4 GLAND	842045	5013866059100	01/01/1900	08/03/2022	£0.00
5	G5 GLAND	850301	5013866059827	01/01/1900	08/03/2022	£0.00
5	G6 GLAND	850302	5013866059834	01/01/1900	08/03/2022	£0.00
5	G7 GLAND	850303	5013866059841	01/01/1900	08/03/2022	£0.00
5	G14 GLAND	852160	5013866063961	01/01/1900	08/03/2022	£0.00
5	G9 GLAND	850306	5013866059858	01/01/1900	To Current	£4.31
5	G1 GLAND	855236	5013866065163	01/01/1900	08/03/2022	£0.00
5	G1 GLAND	855236	5013866065163	01/01/1900	08/03/2022	£0.00
5	G3 GLAND	842043	5013866059094	01/01/1900	To Current	£2.59
5	G3 GLAND	842043	5013866059094	01/01/1900	To Current	£2.59
5	G4 GLAND	842045	5013866059100	01/01/1900	08/03/2022	£0.00
5	G5 GLAND	850301	5013866059827	01/01/1900	08/03/2022	£0.00
5	G6 GLAND	850302	5013866059834	01/01/1900	08/03/2022	£0.00

Spare Key	Description	Code	Barcode	Date From	Date To	Price (£) ex VAT
5	G7 GLAND	850303	5013866059841	01/01/1900	08/03/2022	£0.00
Spare Key	Description	Code	Barcode	Date From	Date To	Price (£) ex VAT
6						
6	GP2 GLAND PACKING	855248	5013866065217	01/01/1900	04/10/2022	£1.68
6	GP2 GLAND PACKING	855248	5013866065217	01/01/1900	04/10/2022	£1.68
6	GP3 GLAND PACKING	842040	5013866059070	01/01/1900	To Current	£1.68
6	GP3 GLAND PACKING	842040	5013866059070	01/01/1900	To Current	£1.68
6	GP4 GLAND PACKING	842042	5013866059087	01/01/1900	04/10/2022	£1.68
6	GP5 GLAND PACKING	850006	5013866059292	01/01/1900	05/10/2022	£1.68
6	GP6 GLAND PACKING	850079	5013866059506	01/01/1900	03/11/2022	£2.18
6	GP24 GLAND PACKING	852950	5013866064029	01/01/1900	04/10/2022	£3.01
6	GP25 GLAND PACKING - DISCONTINUED	852953	5013866064036	01/01/1900	To Current	£0.00
6	GP15 GLAND PACKING	850330	5013866060052	01/01/1900	To Current	£3.38
6	GP2 GLAND PACKING	855248	5013866065217	01/01/1900	04/10/2022	£1.68
6	GP2 GLAND PACKING	855248	5013866065217	01/01/1900	04/10/2022	£1.68
6	GP3 GLAND PACKING	842040	5013866059070	01/01/1900	To Current	£1.68
6	GP3 GLAND PACKING	842040	5013866059070	01/01/1900	To Current	£1.68
6	GP4 GLAND PACKING	842042	5013866059087	01/01/1900	04/10/2022	£1.68
6	GP5 GLAND PACKING	850006	5013866059292	01/01/1900	05/10/2022	£1.68
6	GP6 GLAND PACKING	850079	5013866059506	01/01/1900	03/11/2022	£2.18