

Pegler Valve

Forged brass full way gate valve

1065 Gate valve



General Information

Size	Pattern No.	Pack 1 Qty	Pack 2 Qty	Code	Barcode	Price (£) each ex VAT
1/2"	1065	10	0	202007	5013866014741	£32.74
3/4"	1065	10	0	202008	5013866014758	£40.62
1"	1065	5	0	202009	5013866014765	£59.84
1.1/4"	1065	5	0	202010	5013866014772	£90.52
1.1/2"	1065	2	0	202011	5013866014789	£126.80
2"	1065	2	0	202012	5013866014796	£176.34
1/2"	1065 AT	10	0	202042	5022050233769	£32.74
3/4"	1065 AT	10	0	202043	5022050233806	£40.62
1"	1065 AT	5	0	202044	5022050233844	£59.84
1.1/4"	1065 AT	5	0	202045	5022050233882	£90.52
1.1/2"	1065 AT	2	0	202046	5022050233318	£126.80
2"	1065 AT	2	0	202047	5022050233356	£176.34
1/2"	1065 PT	10	0	202052	5022050397652	£32.74
3/4"	1065 PT	10	0	202053	5022050397706	£40.62
1"	1065 PT	5	0	202054	5022050397720	£59.84
1.1/4"	1065 PT	5	0	202055	5022050397744	£90.52
1.1/2"	1065 PT	2	0	202056	5022050397768	£126.80
2"	1065 PT	2	0	202057	5022050397782	£176.34

1065 Gate valve

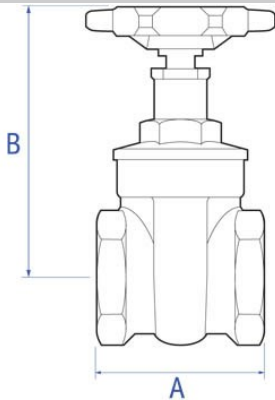

Dimensions

Code	Description	A	B
202007	1/2" 1065	46 70	0.27
202008	3/4" 1065	50 80	0.37
202009	1" 1065	57 95	0.58
202010	1.1/4" 1065	64 115	0.94
202011	1.1/2" 1065	68 125	1.19
202012	2" 1065	81 155	2.09
202042	1/2" 1065 AT	46 70	0.27
202043	3/4" 1065 AT	50 80	0.37
202044	1" 1065 AT	57 95	0.58
202045	1.1/4" 1065 AT	64 115	0.94
202046	1.1/2" 1065 AT	68 125	1.19
202047	2" 1065 AT	81 155	2.09
202052	1/2" 1065 PT	46 70	0.27
202053	3/4" 1065 PT	50 80	0.37
202054	1" 1065 PT	57 95	0.58
202055	1.1/4" 1065 PT	64 115	0.94
202056	1.1/2" 1065 PT	68 125	1.19
202057	2" 1065 PT	81 155	2.09

Pegler Yorkshire reserve the right to change specifications

Flow Rate

Size	Pattern No.	Code	Kv m3/h	Cv - US GPM
1/2"	1065	202007	14.00	-
3/4"	1065	202008	32.00	-

Size Pattern No. Code Kv m3/h Cv - US GPM

1"	1065	202009	57.00	-
1.1/4"	1065	202010	90.00	-
1.1/2"	1065	202011	129.00	-
2"	1065	202012	230.00	-
1/2"	1065 AT	202042	14.00	16.40
3/4"	1065 AT	202043	32.00	37.40
1"	1065 AT	202044	57.00	66.70
1.1/4"	1065 AT	202045	90.00	105.30
1.1/2"	1065 AT	202046	129.00	150.90
2"	1065 AT	202047	230.00	269.10
1/2"	1065 PT	202052		
3/4"	1065 PT	202053		
1"	1065 PT	202054		
1.1/4"	1065 PT	202055		
1.1/2"	1065 PT	202056		
2"	1065 PT	202057		

Pegler Yorkshire reserve the right to change specifications

Pressure and Temperature

Description	Minimum Operating Pressure (bar)	Maximum Cold Working Pressure (bar)	Maximum Hot Working Pressure (bar)
1065 Gate valve	No Minimum Operating Pressure	17.5 bar at temperatures down to -10°C	17.5 bar at temperatures up to 93°C

Care and Maintenance

Care

No regular aesthetic care is required for this product

Maintenance

A regular maintenance program is the most efficient method of ensuring longer term operational efficiency of the selected valve. Such a program would need to include a risk assessment and a planned procedure of how the maintenance will be carried out. The possibility of operational limits being exceeded and the potential hazards ensuring must be considered as part of this assessment. This should be implemented to include visual checks on the valve's condition and any development of unforeseen conditions, which could lead to failure. The correct fitting tools and equipment should be used for valve maintenance work. Separate means of draining the pipe work must be provided when carrying out any maintenance to valves. Where there may be any system debris this could be collected and /or filtered by installation of the appropriate protective device.

For further help please contact your local engineer.

If your product is under warranty please contact the Service Support Team on: 0800 1560050

Regulations

Regulations

THE PRESSURE EQUIPMENT DIRECTIVE 97/23/EC and CE MARKING

The Pressure Equipment Regulations 1999 (SI 1999/2001) have now been introduced into United Kingdom law.

Valves with a maximum allowable pressure greater than 0.5 bar are covered by these new Regulations. Valves are categorised according to their maximum working pressure, size and rising level of hazard. The level of hazard varies according to the fluid being carried. Fluids are classified as Group 1, dangerous fluids or Group 2, all other fluids including steam. The Categories designated are SEP (sound engineering practice). Valves up to and including 25mm (1") are designated SEP regardless of the fluid group. Those identified as having increased hazard are Categorised as, I, II, III or IV. All valves designated as SEP do not bear the CE mark nor require a Declaration of Conformity. Categories I, II, III or IV carry the CE mark and require a Declaration of Conformity. Valves classified from the piping chart would not be included in Category IV.

Size Pattern No. Code PED Categorisation

1/2"	1065	202007	SEP
3/4"	1065	202008	SEP
1"	1065	202009	SEP

Size Pattern No. Code PED Categorisation

1.1/4"	1065	202010	SEP
1.1/2"	1065	202011	SEP
2"	1065	202012	SEP
1/2"	1065 AT	202042	-
3/4"	1065 AT	202043	-
1"	1065 AT	202044	-
1.1/4"	1065 AT	202045	-
1.1/2"	1065 AT	202046	-
2"	1065 AT	202047	-
1/2"	1065 PT	202052	-
3/4"	1065 PT	202053	-
1"	1065 PT	202054	-
1.1/4"	1065 PT	202055	-
1.1/2"	1065 PT	202056	-
2"	1065 PT	202057	-

Pegler Yorkshire reserve the right to change specifications

Materials

Component	Material
Body	Forged Brass
Bonnet	Forged Brass
Stem	Brass Bar
Wedge	Forged Brass
Gland Screw	Brass Bar
Handwheel	Aluminium
Handwheel Nut	Brass Bar
O Rings	Nitrile Rubber
Rating Disc	Aluminium

Technical Suitability

Steam	Water	Oil	Air	Gas	Inert Gas	Combustible†	Gas Corrosive††	Gas Oxygen
no	yes	yes	no	no	no	no	no	no

Pegler Yorkshire reserve the right to change specifications

Gas application guide

- Class 1. INERT Air, argon, carbon dioxide, helium, nitrogen
- Class 2. COMBUSTIBLE Hydrogen, methane, natural gas, town gas
- Class 3. CORROSIVE Chlorine, sulphur dioxide Class 4. OXYGEN

† Valves are suitable for British Gas Applications Family Gases 1, 2 and 3.
 †† Suitable in applications where moisture is completely absent.

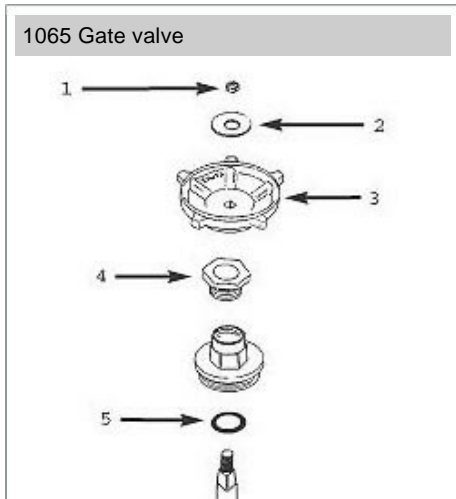

Spare Key	Description	Code	Barcode	Date From	Date To	Price (£) ex VAT
1						
1	WN1 HANDWHEEL NUT BRASS (M5)	850481	5013866060977	01/01/1900	To Current	£0.94
1	WN1 HANDWHEEL NUT BRASS (M5)	850481	5013866060977	01/01/1900	To Current	£0.94
1	WN1 HANDWHEEL NUT BRASS (M5)	850481	5013866060977	01/05/1997	To Current	£0.94
1	WN2 HANDWHEEL NUT BRASS (M6)	850482	5013866060984	01/01/1990	30/04/1997	£0.94
1	WN2 HANDWHEEL NUT BRASS (M6)	850482	5013866060984	01/01/1900	To Current	£0.94
1	WN2 HANDWHEEL NUT BRASS (M6)	850482	5013866060984	01/01/1900	To Current	£0.94
1	WN2 HANDWHEEL NUT BRASS (M6)	850482	5013866060984	01/01/1900	To Current	£0.94



Spare Key	Description	Code	Barcode	Date From	Date To	Price (£) ex VAT
(M6)						
Spare Key	Description	Code	Barcode	Date From	Date To	Price (£) ex VAT
2						
2	RATING DISC 1065 - SIZE 1	850421	5013866060557	01/01/1900	To Current	£1.07
2	RATING DISC 1065 - SIZE 1	850421	5013866060557	01/01/1900	To Current	£1.07
2	RATING DISC 1065 - SIZE 1	850421	5013866060557	01/01/1900	To Current	£1.07
2	RATING DISC 1065 - SIZE 1	850421	5013866060557	01/01/1900	To Current	£1.07
2	RATING DISC 1065 - SIZE 1	850421	5013866060557	01/01/1900	To Current	£1.07
2	RATING DISC 1065 - SIZE 1	850421	5013866060557	01/01/1900	To Current	£1.07
Spare Key	Description	Code	Barcode	Date From	Date To	Price (£) ex VAT
3						
3	W1 HANDWHEEL (RED)	850100	5013866059513	01/01/1900	To Current	£12.90
3	W1 HANDWHEEL (RED)	850100	5013866059513	01/01/1900	To Current	£12.90
3	W3 HANDWHEEL (RED)	850101	5013866059520	01/05/1997	To Current	£12.90
3	W4 HANDWHEEL (RED)	850102	5013866059537	01/01/1990	30/04/1997	£12.90
3	W5 HANDWHEEL (RED)	850103	5013866059544	01/01/1900	To Current	£12.90
3	W6 HANDWHEEL (RED)	850104	5013866059551	01/01/1900	To Current	£20.44
3	W7 HANDWHEEL (RED)	850105	5013866059568	01/01/1900	To Current	£20.44
Spare Key	Description	Code	Barcode	Date From	Date To	Price (£) ex VAT
4						
4	GS2 GLAND SCREW	850336	5013866060090	01/01/1900	08/03/2022	£0.00
4	GS2 GLAND SCREW	850336	5013866060090	01/01/1900	08/03/2022	£0.00
4	GS5 GLAND SCREW	850339	5013866060120	01/01/1900	08/03/2022	£0.00
4	GS7 GLAND SCREW	850341	5013866060137	01/01/1900	08/03/2022	£0.00
4	GS9 GLAND SCREW	850343	5013866060151	01/01/1900	08/03/2022	£0.00
4	GS11 GLAND SCREW	850345	5013866060175	01/01/1900	08/03/2022	£0.00
Spare Key	Description	Code	Barcode	Date From	Date To	Price (£) ex VAT
5						
5	OR28 O RING	850370	5013866060281	01/01/1900	To Current	£0.00
5	OR28 O RING	850370	5013866060281	01/01/1900	To Current	£0.00
5	OR29 O RING	850371	5013866060298	01/01/1900	08/03/2022	£0.00
5	OR30 O RING	850372	5013866060304	01/01/1900	08/03/2022	£0.00
5	OR31 O RING	850373	5013866060311	01/01/1900	To Current	£0.00
5	OR32 O RING	850374	5013866060328	01/01/1900	08/03/2022	£0.00