

Pegler Valve

Bronze full way gate valve with lockshield. BS 5154 PN20 Series B. BS21 Taper thread

1070/125 LS Gate valve



General Information

| Size | Pattern No. | Pack 1 Qty | Pack 2 Qty | Code | Barcode | Price (£) each ex VAT |
|--------|-------------|------------|------------|------------------------|---------------|-----------------------|
| 1/2" | 1070/125 LS | 10 | 0 | 103057 | 5022050231765 | £24.91 |
| 3/4" | 1070/125 LS | 5 | 0 | 103058 | 5022050231987 | £40.10 |
| 1" | 1070/125 LS | 5 | 0 | 103059 | 5022050232243 | £63.91 |
| 1.1/4" | 1070/125 LS | 2 | 0 | 103060 | 5022050232359 | £89.15 |
| 1.1/2" | 1070/125 LS | 2 | 0 | 103061 | 5022050232519 | £116.10 |
| 2" | 1070/125 LS | 2 | 0 | 103062 | 5022050232595 | £189.28 |

1070/125 LS Gate valve

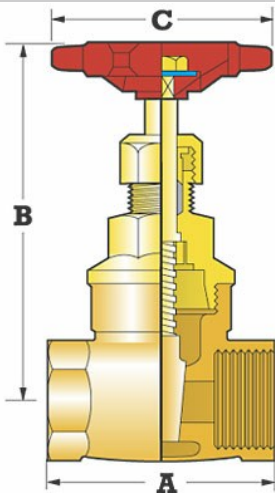

Dimensions

| Code | Description | A | B |
|--------|---------------------------------|--------|------|
| 103057 | 1/2" 1070/125 LS GM GATEVALVE | 52.75 | 0.29 |
| 103058 | 3/4" 1070/125 LS GM GATEVALVE | 56.85 | 0.43 |
| 103059 | 1" 1070/125 LS GM GATEVALVE | 65.100 | 0.67 |
| 103060 | 1.1/4" 1070/125 LS GM GATEVALVE | 73.110 | 0.99 |
| 103061 | 1.1/2" 1070/125 LS GM GATEVALVE | 76.130 | 1.30 |
| 103062 | 2" 1070/125 LS GM GATEVALVE | 90.155 | 2.28 |

Pegler Yorkshire reserve the right to change specifications

Flow Rate

| Size | Pattern No. | Code | Kv m3/h |
|--------|-------------|--------|---------|
| 1/2" | 1070/125 LS | 103057 | 14.00 |
| 3/4" | 1070/125 LS | 103058 | 32.00 |
| 1" | 1070/125 LS | 103059 | 57.00 |
| 1.1/4" | 1070/125 LS | 103060 | 90.00 |
| 1.1/2" | 1070/125 LS | 103061 | 129.00 |
| 2" | 1070/125 LS | 103062 | 230.00 |

Pegler Yorkshire reserve the right to change specifications

Pressure and Temperature

| Description | Minimum Operating Pressure (bar) | Maximum Cold Working Pressure (bar) | Maximum Hot Working Pressure (bar) |
|------------------------|----------------------------------|--------------------------------------|------------------------------------|
| 1070/125 LS Gate valve | No Minimum Operating Pressure | 20.0 bar at temperatures up to 100oC | 9 bar at temperatures up to 180oC |

Technical Suitability

Steam Water Oil Air Gas Inert Gas Combustible† Gas Corrosive†† Gas Oxygen

no yes yes no no no no no

Pegler Yorkshire reserve the right to change specifications

Gas application guide

Class 1. INERT Air, argon, carbon dioxide, helium, nitrogen

Class 2. COMBUSTIBLE Hydrogen, methane, natural gas, town gas

Class 3. CORROSIVE Chlorine, sulphur dioxide Class 4. OXYGEN

Class 1. INERT Air, argon, carbon dioxide, helium, nitrogen

† Valves are suitable for British Gas Applications Family Gases 1, 2 and 3.

†† Suitable in applications where moisture is completely absent.

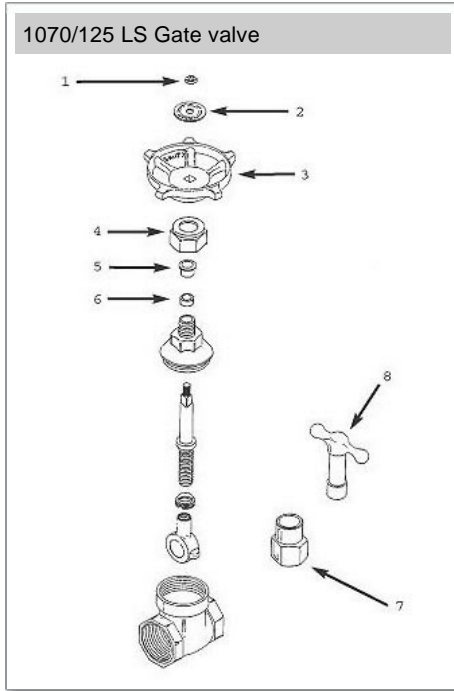

| Spare Key | Description | Code | Barcode | Date From | Date To | Price (£) ex VAT |
|-----------|--------------------|--------|---------------|------------|------------|------------------|
| 5 | | | | | | |
| 5 | G16 GLAND | 850485 | 5013866061011 | 01/01/1900 | 08/03/2022 | £0.00 |
| 5 | G16 GLAND | 850485 | 5013866061011 | 01/01/1900 | 08/03/2022 | £0.00 |
| 5 | G17 GLAND | 850486 | 5013866061028 | 01/01/1900 | 08/03/2022 | £0.00 |
| 5 | G18 GLAND | 815202 | 5013866057274 | 01/01/1900 | 08/03/2022 | £0.00 |
| 5 | G19 GLAND | 850487 | 5013866061035 | 01/01/1900 | 08/03/2022 | £0.00 |
| 5 | G20 GLAND | 850488 | 5013866061042 | 01/01/1900 | 08/03/2022 | £0.00 |
| 6 | | | | | | |
| 6 | GP12 GLAND PACKING | 850327 | 5013866060021 | 01/01/1900 | 08/03/2022 | £0.00 |
| 6 | GP12 GLAND PACKING | 850327 | 5013866060021 | 01/01/1900 | 08/03/2022 | £0.00 |
| 6 | GP8 GLAND PACKING | 855241 | 5013866065187 | 01/01/1900 | 03/11/2022 | £1.68 |
| 6 | GP10 GLAND PACKING | 850325 | 5013866060007 | 01/01/1900 | 04/10/2022 | £1.68 |
| 6 | GP9 GLAND PACKING | 855247 | 5013866065200 | 01/01/1900 | 08/03/2022 | £0.00 |
| 6 | GP16 GLAND PACKING | 855245 | 5013866065194 | 01/01/1900 | 04/10/2022 | £2.18 |
| 7 | | | | | | |
| 7 | LS6 LOCKSHIELD | 855238 | 5013866065170 | 01/01/1900 | 08/03/2022 | £0.00 |
| 7 | LS6 LOCKSHIELD | 855238 | 5013866065170 | 01/01/1900 | 08/03/2022 | £0.00 |
| 7 | LS3 LOCKSHIELD | 850152 | 5013866059681 | 01/01/1900 | 08/03/2022 | £0.00 |
| 7 | LS9 LOCKSHIELD | 815201 | 5013866057267 | 01/01/1900 | 08/03/2022 | £0.00 |
| 7 | LS13 LOCKSHIELD | 850416 | 5013866060502 | 01/01/1900 | 08/03/2022 | £0.00 |
| 7 | LS14 LOCKSHIELD | 850367 | 5013866060250 | 01/01/1900 | 08/03/2022 | £0.00 |
| 8 | | | | | | |
| 8 | K9 LOCKSHIELD KEY | 850139 | 5013866059650 | 01/01/1900 | To Current | £0.00 |
| 8 | K9 LOCKSHIELD KEY | 850139 | 5013866059650 | 01/01/1900 | To Current | £0.00 |
| 8 | K2 LOCKSHIELD KEY | 817020 | 5013866058448 | 01/01/1900 | To Current | £12.42 |
| 8 | K3 LOCKSHIELD KEY | 850132 | 5013866059612 | 01/01/1900 | 08/03/2022 | £0.00 |
| 8 | K5 LOCKSHIELD KEY | 850134 | 5013866059629 | 01/01/1900 | 08/03/2022 | £0.00 |
| 8 | K6 LOCKSHIELD KEY | 850135 | 5013866059636 | 01/01/1900 | 08/03/2022 | £0.00 |