

Pegler Valve

Bronze gland cock, male x hose union 10 Bar 120°C, ISO 228 (BS 2779), parallel thread (PT)

1832 Gland cock



General Information

Size	Pattern No.	Pack 1 Qty	Pack 2 Qty	Code	Barcode	Price (£) each ex VAT
1/2"	1832	5	0	<u>130007</u>	5013866014383	£74.42
3/4"	1832	4	0	<u>130008</u>	5013866014390	£108.50
1"	1832	2	0	<u>130009</u>	5013866014406	£168.21

1832 Gland cock

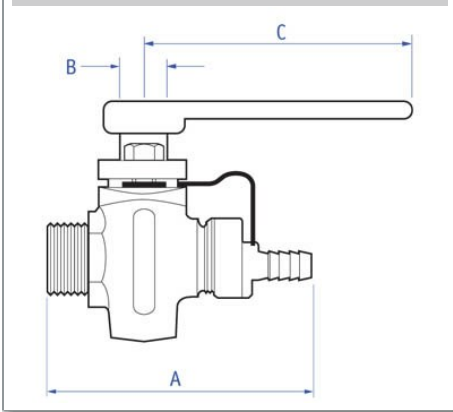

Dimensions

Code	Description	A	B	C
130007	1/2" 1832 GM HU GLAND COCK 93	10	86	0.44
130008	3/4" 1832 GM HU GLAND COCK 117	14	95	0.76
130009	1" 1832 GM HU GLAND COCK 145	16	121	1.32

Pegler Yorkshire reserve the right to change specifications

Flow Rate

Size	Pattern No.	Code	Kv m3/h
1/2"	1832	130007	17.00
3/4"	1832	130008	41.00
1"	1832	130009	70.00

Pegler Yorkshire reserve the right to change specifications

Pressure and Temperature

Description	Minimum Operating Pressure (bar)	Maximum Cold Working Pressure (bar)	Maximum Hot Working Pressure (bar)
1832 Gland cock	No Minimum Operating Pressure	10.0 bar at temperatures up to 120oC	Not Suitable for Maximum Hot Working Pressure

Care and Maintenance

Care

No regular aesthetic care is required for this product

Maintenance

A regular maintenance program is the most efficient method of ensuring longer term operational efficiency of the selected valve. Such a program would need to include a risk assessment and a planned procedure of how the maintenance will be carried out. The possibility of operational limits being exceeded and the

potential hazards ensuring must be considered as part of this assessment. This should be implemented to include visual checks on the valve's condition and any development of unforeseen conditions, which could lead to failure. The correct fitting tools and equipment should be used for valve maintenance work. Separate means of draining the pipe work must be provided when carrying out any maintenance to valves. Where there may be any system debris this could be collected and /or filtered by installation of the appropriate protective device.

For further help please contact your local engineer.

If your product is under warranty please contact the Service Support Team on: 0800 1560050

Regulations

Regulations

THE PRESSURE EQUIPMENT DIRECTIVE 97/23/EC and CE MARKING

The Pressure Equipment Regulations 1999 (SI 1999/2001) have now been introduced into United Kingdom law.

Valves with a maximum allowable pressure greater than 0.5 bar are covered by these new Regulations. Valves are categorised according to their maximum working pressure, size and rising level of hazard. The level of hazard varies according to the fluid being carried. Fluids are classified as Group 1, dangerous fluids or Group 2, all other fluids including steam. The Categories designated are SEP (sound engineering practice). Valves up to and including 25mm (1") are designated SEP regardless of the fluid group. Those identified as having increased hazard are Categorised as, I, II, III or IV. All valves designated as SEP do not bear the CE mark nor require a Declaration of Conformity. Categories I, II, III or IV carry the CE mark and require a Declaration of Conformity. Valves classified from the piping chart would not be included in Category IV.

Size Pattern No. Code PED Categorisation

1/2"	1832	130007	SEP
3/4"	1832	130008	SEP
1"	1832	130009	SEP

Pegler Yorkshire reserve the right to change specifications

Materials

Component	Material
Body	Gunmetal
Plug	Gunmetal
Gland	Brass Bar (1/2" and 3/4") Forged Brass (1")
Bolt	Brass Bar
Gland Packing	PTFE
Lever	Cast Iron
Pipe	Brass Bar
Boss	Brass Bar (1/2") Forged Brass (3/4" and 1")
Cap	Brass Bar
O Ring	WRc Approved Rubber
O Ring or Washer	O Ring - WRc Approved Rubber (1/2") Washer - Akulon (3/4" and 1")
Strap	Nylon 6

Technical Suitability

Steam Water Oil Air Gas Inert Gas Combustible† Gas Corrosive†† Gas Oxygen

no yes yes no no no no no

Pegler Yorkshire reserve the right to change specifications

Gas application guide

Class 1. INERT Air, argon, carbon dioxide, helium, nitrogen

Class 2. COMBUSTIBLE Hydrogen, methane, natural gas, town gas

Class 3. CORROSIVE Chlorine, sulphur dioxide Class 4. OXYGEN

Class 1. INERT Air, argon, carbon dioxide, helium, nitrogen

† Valves are suitable for British Gas Applications Family Gases 1, 2 and 3.

†† Suitable in applications where moisture is completely absent.

1832 Gland cock

Spare Key	Description	Code	Barcode	Date From	Date To	Price (£) ex VAT
-----------	-------------	------	---------	-----------	---------	------------------

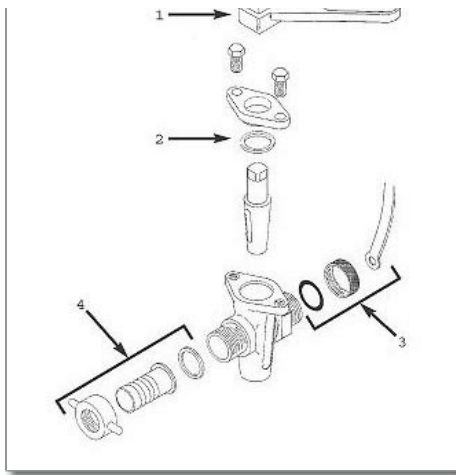

Spare Key	Description	Code	Barcode	Date From	Date To	Price (£) ex VAT
1	L2 LEVER	850052	5013866059377	01/01/1900	08/03/2022	£0.00
1	L3.1/2 LEVER	850054	5013866059391	01/01/1900	To Current	£23.73
1	L4.1/2 LEVER	850056	5013866059407	01/01/1900	04/10/2022	£34.39
2						
2	PD2 PACKING DISC	850027	5013866059315	01/01/1900	04/10/2022	£1.07
2	PD3 PACKING DISC	850376	5013866060342	01/01/1900	To Current	£1.52
2	PD4 PACKING DISC	850377	5013866060359	01/01/1900	04/10/2022	£4.76
3						
3	CS1 CAP AND STRAP	855100	5013866065149	01/01/1900	To Current	£5.13
3	CS2 CAP AND STRAP	855101	5013866065156	01/01/1900	To Current	£6.02
3	CS3 CAP AND STRAP	851500	5013866063947	01/01/1900	08/03/2022	£0.00
4						
4	HU4 HOSE UNION	817006	5013866058394	01/01/1900	To Current	£6.25
4	HU9 HOSE UNION	850495	5013866061103	01/01/1900	08/03/2022	£0.00
4	HU10 HOSE UNION	850496	5013866061110	01/01/1900	08/03/2022	£0.00