

Endex

Male adaptor, male copper, for insertion into fitting x BSP taper male thread

N8/4280G Adaptor



General Information

Key Features

- Male copper for insertion into fix BSP taper male

Size	Pattern No.	Pack 1 Qty	Pack 2 Qty	Code	Barcode	Price (£) each ex VAT
15mm x 1/2"	N8/4280G	10	200	88330	5022050883308	£3249.71 per 100
22mm x 3/4"	N8/4280G	10	150	88331	5022050883315	£4425.65 per 100
28mm x 1"	N8/4280G	10	80	88332	5022050883322	£6405.22 per 100
35mm x 1.1/4"	N8/4280G	1	25	88333	5022050593498	£9527.76 per 100
42mm x 1.1/2"	N8/4280G	1	20	88334	5022050593504	£13172.03 per 100
54mm x 2"	N8/4280G	1	15	88335	5022050593511	£17697.45 per 100

N8/4280G Adaptor

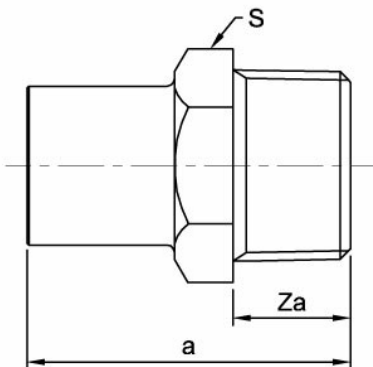

Dimensions

Code	Description	a	Za	s
88330	15mm x 1/2" N8/4280G	37	15	24
88331	22mm x 3/4" N8/4280G	40	16	25
88332	28mm x 1" N8/4280G	46	17	32
88333	35mm x 1 1/4" N8/4280G	54	20	40
88334	42mm x 1 1/2" N8/4280G	61	20	50
88335	54mm x 2" N8/4280G	63	21	60

Pegler Yorkshire reserve the right to change specifications

Guarantee

Pegler 25 Year Guarantee - Terms and Conditions

Products are subject to a 25 year guarantee that is between Pegler and the final purchaser of the product.

The guarantee is subject to proof of purchase being supplied.

This guarantee does not affect any statutory rights the consumer may have in law.

The guarantee covers manufacturing or material defects when installed in accordance with our instructions on specified tube materials and applications, and does not cover parts subject to normal wear and tear.

This product range has been designed for the use of homeowners, domestic and commercial applications and therefore the Guarantee is subject to the product being properly selected for their intended service conditions.

The guarantee is not applicable where the product is fitted contrary to the conditions in the fitting instructions.

This is reinforced where valves are covered by the European Pressure Equipment Directive (PED97/23/EC) where Installation, Operating and Maintenance Instructions are supplied with each product and/or carton.

Provided it is installed correctly and receives adequate preventative maintenance it should give years of trouble-free service.

Abusive behaviour and accidental damage to the product are not covered by this guarantee.

The extent of this liability is limited to the cost of the replacement of the defective item and not to installation or consequential damages.

Pressure and Temperature

Size	-40°C (Min)	30°C	65°C	110°C (Max)
6mm to 28mm	25bar	25bar	25bar	16bar
35mm to 54mm	25bar	25bar	16bar	10bar
67mm	16bar	16bar	16bar	10bar

Size	-15°C (Min)	30°C	65°C	110°C (Max)
6mm to 54mm	16bar	16bar	10bar	6bar
67mm	10bar	10bar	6bar	4bar

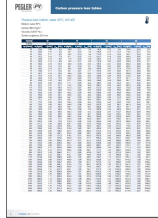

Pressure Loss Tables: Copper Water

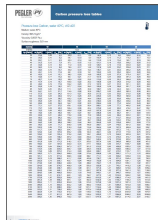

Pressure Loss Tables: Copper Compressed Air

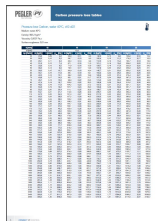

Pressure Loss Tables: Copper Gas

Care and Maintenance

Care

No regular aesthetic care is required for this product

Maintenance

No regular maintenance is required for this product.

For any further help please contact the Service Support Team on: 0800 1560050.