

Pegler Valve

DZR Brass full bore ball valve with lockshield. Female ends, PN25

PB550LS Ball valve



General Information

Size	Pattern No.	Pack 1 Qty	Pack 2 Qty	Code	Barcode	Price (£) each ex VAT
1/2"	PB550LS	10	0	245260	5022050213013	£21.24
3/4"	PB550LS	10	0	245261	5022050213433	£31.33
1"	PB550LS	5	0	245262	5022050213860	£47.97
1.1/4"	PB550LS	1	5	245263	5022050561756	£72.41
1.1/2"	PB550LS	1	2	245264	5022050561763	£95.96
2"	PB550LS	1	2	245265	5022050561787	£162.01

PB550LS Ball valve

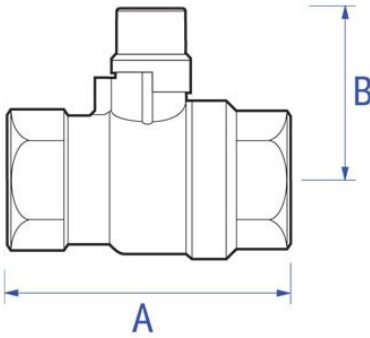

Dimensions

Code	Description	A	B
245260	1/2" PB550LS	59	45 0.21
245261	3/4" PB550LS	68	53 0.37
245262	1" PB550LS	80	58 0.57
245263	1.1/4" PB550LS	95	65 1.15
245264	1.1/2" PB550LS	100	81 1.21
245265	2" PB550LS	124	88 2.79

Pegler Yorkshire reserve the right to change specifications

Flow Rate

Size	Pattern No.	Code	Kv m3/h
1/2"	PB550LS	245260	17.00
3/4"	PB550LS	245261	41.00
1"	PB550LS	245262	70.00
1.1/4"	PB550LS	245263	212.00
1.1/2"	PB550LS	245264	200.00
2"	PB550LS	245265	292.00

Pegler Yorkshire reserve the right to change specifications

Pressure and Temperature

Description	Minimum Operating Pressure (bar)	Maximum Cold Working Pressure (bar)	Maximum Hot Working Pressure (bar)
PB550LS Ball valve	No Minimum Operating Pressure	No Maximum Cold Working Pressure	No Maximum Hot Working Pressure

Care and Maintenance

Care

No regular aesthetic care is required for this product

Maintenance

A regular maintenance program is the most efficient method of ensuring longer term operational efficiency of the selected valve. Such a program would need to include a risk assessment and a planned procedure of how the maintenance will be carried out. The possibility of operational limits being exceeded and the potential hazards ensuring must be considered as part of this assessment. This should be implemented to include visual checks on the valve's condition and any development of unforeseen conditions, which could lead to failure. The correct fitting tools and equipment should be used for valve maintenance work. Separate means of draining the pipe work must be provided when carrying out any maintenance to valves. Where there may be any system debris this could be collected and /or filtered by installation of the appropriate protective device.

For further help please contact your local engineer.

If your product is under warranty please contact the Service Support Team on: 0800 1560050

Regulations

Regulations

THE PRESSURE EQUIPMENT DIRECTIVE 97/23/EC and CE MARKING

The Pressure Equipment Regulations 1999 (SI 1999/2001) have now been introduced into United Kingdom law.

Valves with a maximum allowable pressure greater than 0.5 bar are covered by these new Regulations. Valves are categorised according to their maximum working pressure, size and rising level of hazard. The level of hazard varies according to the fluid being carried. Fluids are classified as Group 1, dangerous fluids or Group 2, all other fluids including steam. The Categories designated are SEP (sound engineering practice). Valves up to and including 25mm (1") are designated SEP regardless of the fluid group. Those identified as having increased hazard are Categorised as, I, II, III or IV. All valves designated as SEP do not bear the CE mark nor require a Declaration of Conformity. Categories I, II, III or IV carry the CE mark and require a Declaration of Conformity. Valves classified from the piping chart would not be included in Category IV.

Size Pattern No. Code PED Categorisation

1/2"	PB550LS	245260	SEP
3/4"	PB550LS	245261	SEP
1"	PB550LS	245262	SEP
1.1/4"	PB550LS	245263	SEP
1.1/2"	PB550LS	245264	SEP
2"	PB550LS	245265	SEP

Pegler Yorkshire reserve the right to change specifications

Materials

Component	Material
Body	DZR brass
Ball	Brass, chrome plated
Stem	DZR brass
Stem 'O' ring	Viton
Seat rings	PTFE (Teflon)
Lever handle	Steel
Lever nut (self locking)	Zinc plated steel
Tee handle security screw	Nickel plated brass
Lockshield dust cap	Plastic
Lockshield	Brass
Lockshield security screw	Brass
Sleeve	Brass (EL)
Ext stem	Brass (EL)
Fixing screw	Steel (EL)
Washer	Brass (EL)

Technical Suitability

Steam	Water	Oil	Air	Gas	Inert Gas	Combustible†	Gas Corrosive††	Gas Oxygen
yes	yes	yes	yes	no	no	no	no	no

Pegler Yorkshire reserve the right to change specifications

Gas application guide

Class 1. INERT Air, argon, carbon dioxide, helium, nitrogen

Class 2. COMBUSTIBLE Hydrogen, methane, natural gas, town gas
Class 3. CORROSIVE Chlorine, sulphur dioxide Class 4. OXYGEN
Class 1. INERT Air, argon, carbon dioxide, helium, nitrogen
† Valves are suitable for British Gas Applications Family Gases 1, 2 and 3.
†† Suitable in applications where moisture is completely absent.

Pegler Yorkshire Group Ltd, St Catherine's Ave, Doncaster, S Yorkshire, DN4 8DF
Telephone: Phone +44 (0) 844 243 4400 Fax: +44 (0) 844 243 9870 Website: www.pegler-yorkshire.co.uk
Registered office : Pegler Yorkshire Group Ltd, St Catherine's Ave, Doncaster, S Yorkshire, DN4 8DF Company no : 00401507