

Pegler Valve

Bronze full way gate valve with lockshield. XPress ends for copper/carbon steel/stainless steel tube

PS1070/125LS Gate valve



General Information

Size	Pattern No.	Pack 1 Qty	Pack 2 Qty	Code	Barcode	Price (£) each ex VAT
15mm	PS1070/125LS 1		10	103311	5022050565181	£43.31
22mm	PS1070/125LS 1		5	103313	5022050565228	£56.47
28mm	PS1070/125LS 1		5	103314	5022050565235	£83.87
35mm	PS1070/125LS 1		5	103315	5022050565242	£118.44
42mm	PS1070/125LS 1		2	103316	5022050565266	£161.87
54mm	PS1070/125LS 1		2	103317	5022050565273	£253.28

PS1070/125LS Gate valve

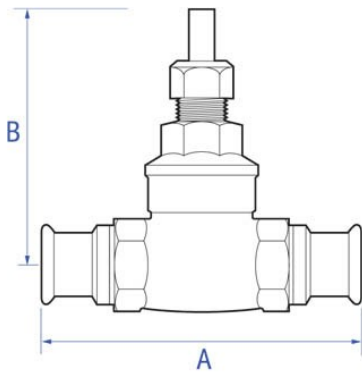

Dimensions

Code	Description	A	B
103311	DN15/15mm PS1070/125LS 98	75	0.39
103313	DN20/22mm PS1070/125LS 104	85	0.56
103314	DN25/28mm PS1070/125LS 117	100	0.84
103315	DN32/35mm PS1070/125LS 130	110	1.26
103316	DN40/42mm PS1070/125LS 141	130	1.69
103317	DN54/54mm PS1070/125LS 165	155	2.67

Pegler Yorkshire reserve the right to change specifications

Flow Rate

Size	Pattern No.	Code	Kv m3/h
15mm	PS1070/125LS	103311	14.00
22mm	PS1070/125LS	103313	32.00
28mm	PS1070/125LS	103314	57.00
35mm	PS1070/125LS	103315	90.00
42mm	PS1070/125LS	103316	129.00
54mm	PS1070/125LS	103317	230.00

Pegler Yorkshire reserve the right to change specifications

Pressure and Temperature

Description	Minimum Operating Pressure (bar)	Maximum Cold Working Pressure (bar)	Maximum Hot Working Pressure (bar)
PS1070/125LS Gate valve	No minimum operating pressure.	16 bar up to 100oC	16 bar up to 100oC

Materials

Component	Material
Body	Gunmetal

Component	Material
Bonnet	Forged brass (1/4" to 3") Gravity die cast brass (4")
Stem	Brass bar
Wedge	Brass
Stem ring	Brass bar
Gland	Brass bar
Gland nut	Brass bar (1/4" to 1") Forged brass (1.1\4" to 4")
Handwheel	Aluminium
Handwheel nut	Brass bar
Gland packing	PTFE
Rating disc	Aluminium
Lockshield	Brass
End connection	Gunmetal body (15 to 54)
End connection 'O' ring	EPDM (15 to 54)

Technical Suitability

Steam	Water	Oil	Air	Gas	Inert Gas	Combustible†	Gas Corrosive††	Gas Oxygen
no	yes	no	no	no	no	no	no	no

Pegler Yorkshire reserve the right to change specifications

Gas application guide

Class 1. INERT Air, argon, carbon dioxide, helium, nitrogen

Class 2. COMBUSTIBLE Hydrogen, methane, natural gas, town gas

Class 3. CORROSIVE Chlorine, sulphur dioxide Class 4. OXYGEN

Class 1. INERT Air, argon, carbon dioxide, helium, nitrogen

† Valves are suitable for British Gas Applications Family Gases 1, 2 and 3.

†† Suitable in applications where moisture is completely absent.